



**Northern Virginia Regional  
Herndon Showcase of Bands  
Saturday, September 28, 2021**

Herndon High School  
700 Bennett Street  
Herndon, VA 20170

# Event Information

VMBC and the Pride of Herndon welcomes you to the 2021 Showcase of Bands!

**PIT Parking:** PIT vehicle parking is on the East Side of the school. Parking volunteers will direct your vehicles upon arrival. **Note departure time for Pit vehicles.**

**Bus Parking:** Buses will be parked in front of school, on Bennett Street or offsite at Adams Center. **If your bus must park offsite, we have storage areas in cafeteria of school for your students to use.**

**Bathrooms** are available for your arrival off cafeteria (door 14) – please refer to map, and /or you will be directed on arrival.

**Field Surface:** Turf

**Awards Ceremony:** There are three Awards Ceremonies. Drum Majors and/or Band Representatives will assemble for the Awards presentation at the band entrance gate before the last band performs in their respective third of the event.

**Feeding your Band:** Due to local ordinances, **no tailgating or grilling of any kind is permitted on the campus or in the surrounding area.** Because of the complex parking situation, food deliveries (e.g. UberEats, pizza deliveries) will not be allowed on the campus.

**Concessions:** Concessions are available next to the stadium during the event. A menu is provided on page 12.

**Pre-Purchased Meals** can be picked up in the cafeteria – you may need multiple people to transport. We recommend your band proceeds to stadium to eat their meals.

**Tickets:** Credit Cards and cash are accepted:

- \$10 General Admission
- \$5 for students age 5-18
- Children 5 and under are free

**Rain Plan:** In the event of inclement weather VMBC and Herndon Event Coordinator will contact directors with delay, standstill, indoor performance or cancellation scenarios.

**Staff/Adult Access into Stadium:** You will receive a Band Director Badge and your instructors and pit crew will be provided wrist bands upon arrival for entrance into the stadium. All other adults must purchase a ticket to enter the stadium as a spectator. Students will not have wrist bands since they will enter the stadium as a group and are usually wearing show shirts.

**Entry to the Stadium Following the Performance:** Your band members are invited into the stadium after their performance free of charge. Entrance for band members in uniform, or in a group if out of uniform is through the main gate. While in the stadium, the band members are to sit in groups, with appropriate supervision. Please remind your students to be respectful of other audience members as well as the bands performing on the field.

**Spectator Parking:** Spectator parking is limited. Spectators may use the 1<sup>st</sup> entrance to the school or park in the Herndon United Methodist Church parking lot across the street (#2 on map page 9). Note there is also parking behind the church. Parking is limited. Spectators may also park in the neighborhood at the end of Bennett Street if all spectator parking is full. There are no parking restrictions in the neighborhoods on Saturdays. If you park in the neighborhood, walk around the front to the left side of the school to get to the ticket booth. Please note the ticket booth is right outside the spectator entrance. (#10 in map page 9)

**Restrooms:** Restrooms are located through Door 11 and 14 at front of school and door 8 at back of school.

**Video:** You may send **one** designated adult to the press box to video tape your own show. You must wait outside press box until just prior to your band performance.

School Construction – we are happy to say since our last event construction has proceeded, but not complete. What this means:

- Some fencing is temporary - please adhere to all signage for proper entrances and exits.
- Some areas for band exit are uneven, or gravel – stick to path
- Concession will be in “food court” outside of stadium entrance in tents
- 3 Water stations one in front of school, one at band entrance and one at band exit near door 8

**Please explain these guidelines to your staff, students and supporters prior to the event.**

**We appreciate your cooperation!**

## CHECK-IN and WARM UP AREAS:

### When you check in:

- Let us know if you will be leaving directly after your performance – this may affect your bus parking.
- Indicate if you choose to go the “Festival” option and not to be scored.
- Turn in payment for prepaid meals at the registration table.
- You will be assigned a warmup area.
- Your band will be assigned guides to stay with your group through performance.
- Your band will exit the bus and follow the guide to the cafeteria to store their personal items (if needed some buses will remain on site) and then return to the warmup area. If you do store your items in the school, pick a contained spot in the room for your band. Other schools will also be storing their items in same room. HHS is not responsible for items stored.
- Your buses will be given parking information and instructions if parking off-site.

### Other reminders:

- Pit will warm-up separately from the rest of the ensemble. Please see the attached map.
- Warm up areas are close together. Please be considerate of other groups if you spread out.
- There is no room for additional marching practice.

### When your performance is over:

Your guide will lead you out of the stadium to a water station. Pit equipment may be returned to the trucks at this time (go left through the concessions area). The majority of the band will be led straight ahead to Door 8 through the building past and out Door 1. Retrieve your personal items (from the bus or cafeteria) as needed and return to the stadium. If your buses are parked off campus, you may leave cases and instruments inside and retrieve them after awards.

### When awards are over:

Please retrieve your personal items and volunteers will direct you through the school to the buses in the front of the school.

**Your patience and flexibility is appreciated as we undergo the final leg of the renovation process. Our volunteers will do everything they can to make this day as smooth and enjoyable as possible!**

## VISITING BAND CHANGING, STORAGE

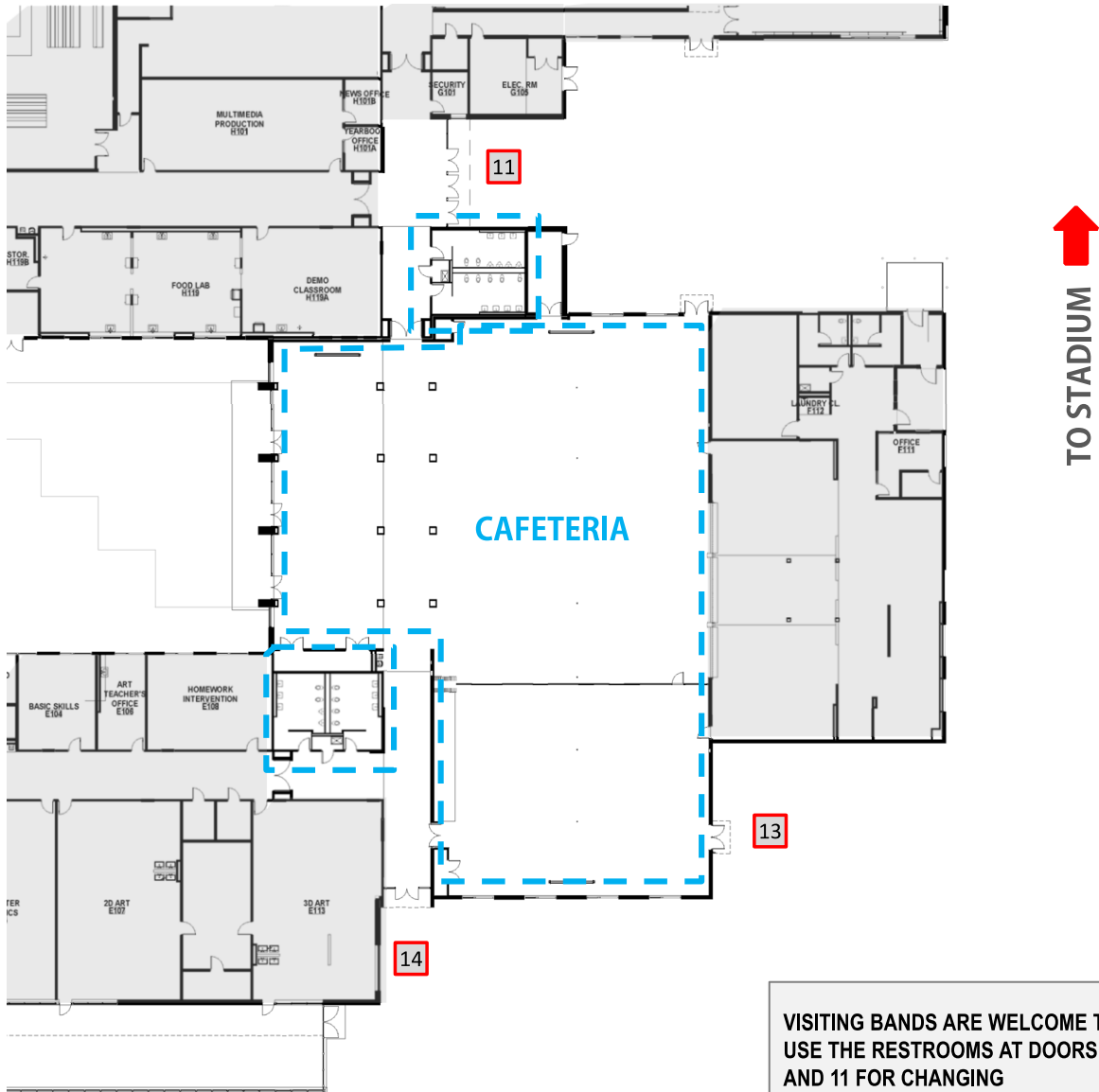

VISITING BANDS ARE WELCOME TO USE THE RESTROOMS AT DOORS 14 AND 11 FOR CHANGING

STUDENTS CAN STORE CASES, ETC. IN THE CAFETERIA

## **PIT PARKING AND WARMUP AREA:**

PIT trucks will enter the campus at the 2<sup>nd</sup> entrance depicted in page 4 to the PIT parking area. Any additional vehicles containing PIT volunteers should use Spectator parking listed above. A PIT Parking representative will direct you to one of the two PIT parking areas. Another representative will direct you to the appropriate parking spots. The PIT vehicles can be unloaded and remain in that spot 45 minutes following your band's performance. They will then need to depart to make room for incoming PIT vehicles. PIT can be unloaded, and a PIT volunteer will direct you to the PIT Warmup Area where your PIT should set up.

There will be **no amplification permitted near the trucks** as we are too close to the stadium

### **When your performance is over:**

Please proceed left through the concessions area along the back of the school to the PIT parking area to load the PIT vehicles.

**Please remember that within 45 minutes following your band's performance all equipment/pit trucks must proceed to the exit (same place you entered).**

## BUS Instructions:

Buses enter the campus at the 2<sup>nd</sup> entrance off Bennett Street. They will either be directed to park in the bus parking area in front of the school or to the bus drop-off area (see map page 8). Once the band members exit the bus – at the direction of the check-in volunteer – the buses will either stay parked in front of school or will be directed to park along Bennett Street or park at the ADAMS Center. Directions will be provided at check-in.

If directed to ADAMS Center (46903 Sugarland Rd, Sterling, VA 20164), the buses will be given a time to report back to the school after the previous sections' buses have left. This will allow the buses to return to campus before their students have performed.

Buses (and trucks) may approach HHS through the nearby neighborhood to avoid Spectator traffic on Bennett Street or may circle around through the neighborhood to reach parking on Bennett Street. See below.

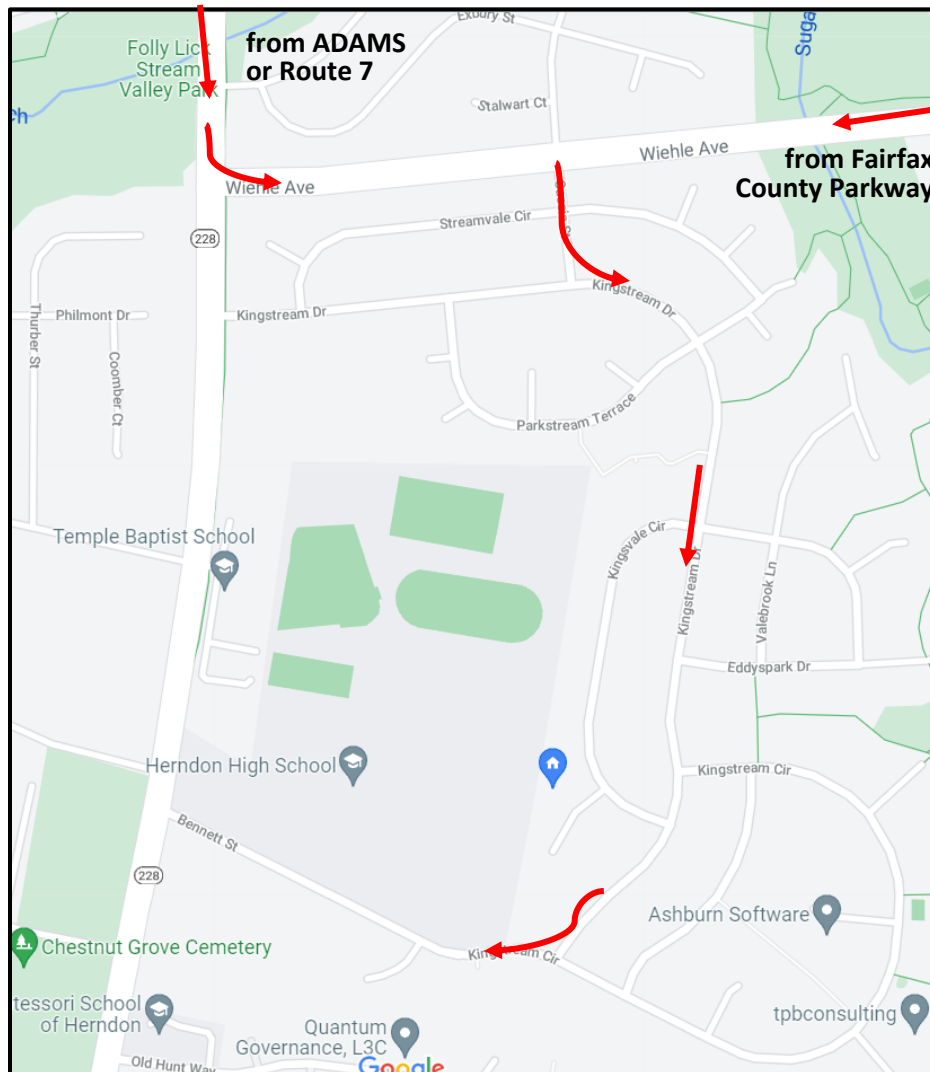

# CAMPUS MAP with Band Stadium Entrance and Exit:

## OVERALL SITE PLAN

# DOOR NUMBER

1 KEY

KEY	
1	VIP, Handicapped parking
2	Spectator parking
3	Performance area
4	First Aid
5	Band Registration
6	Band Changing, Storage
7	Spectator entry

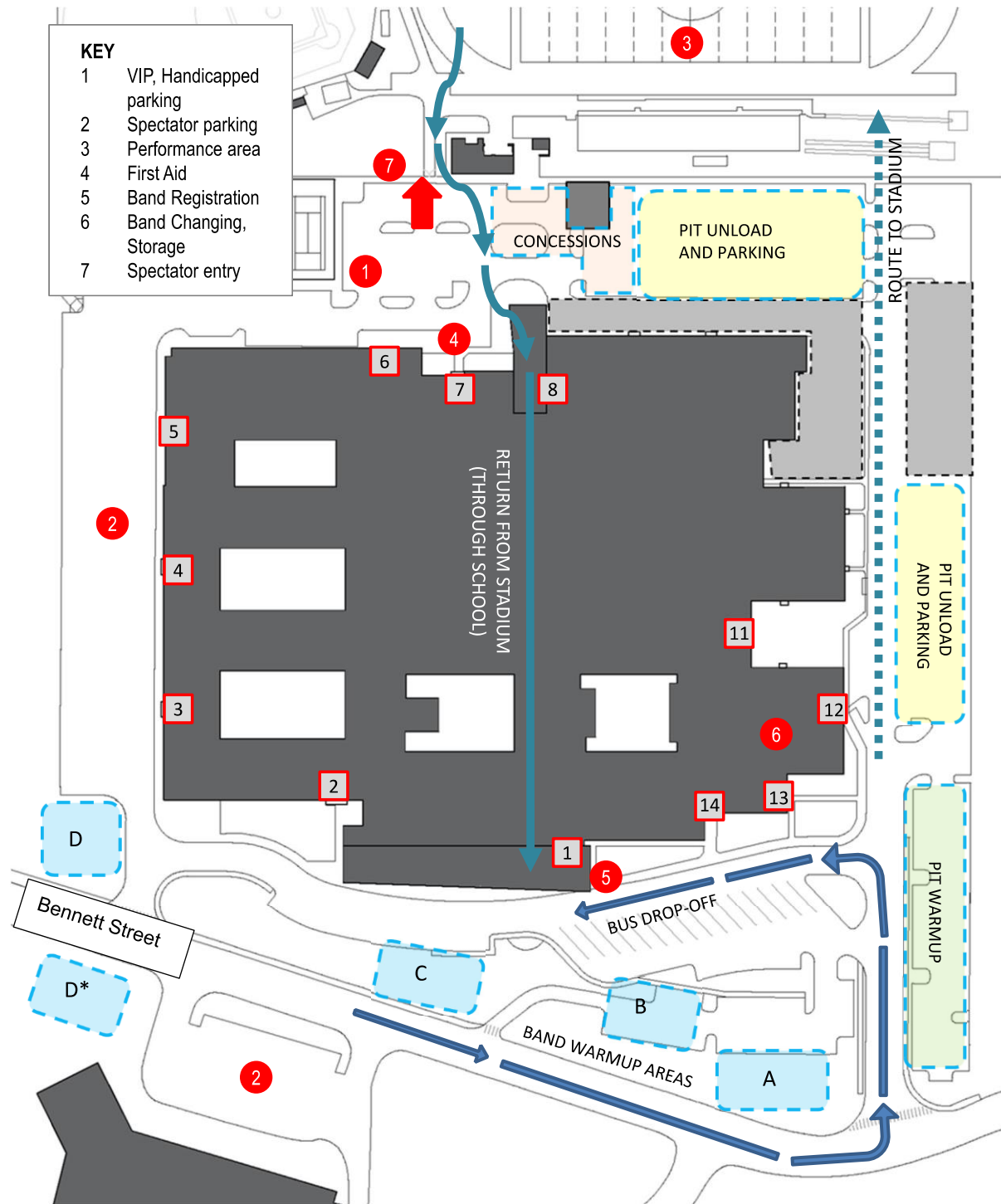



# OVERALL AREA PLAN

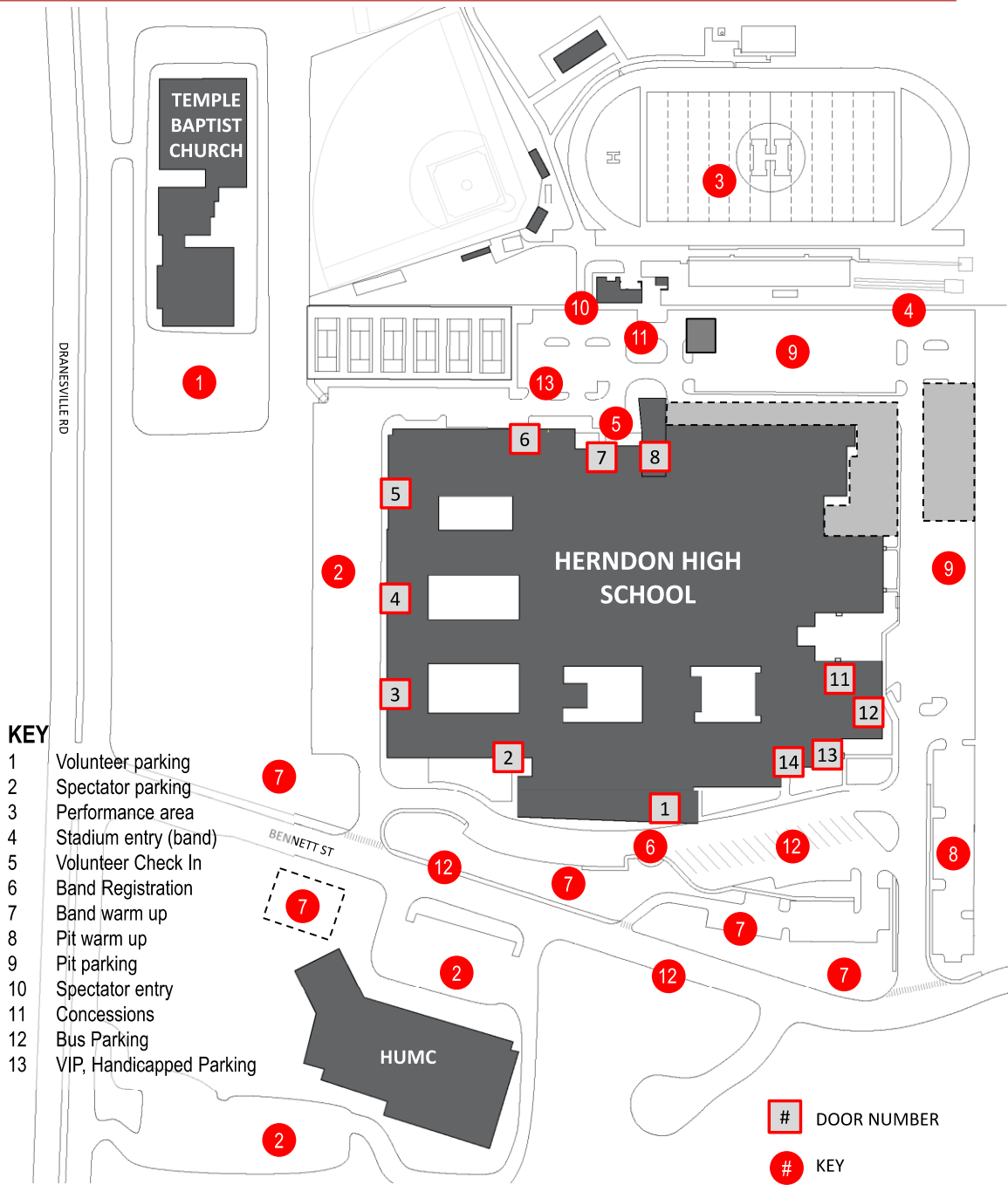

- KEY**
- 1 Volunteer parking
  - 2 Spectator parking
  - 3 Performance area
  - 4 Stadium entry (band)
  - 5 Volunteer Check In
  - 6 Band Registration
  - 7 Band warm up
  - 8 Pit warm up
  - 9 Pit parking
  - 10 Spectator entry
  - 11 Concessions
  - 12 Bus Parking
  - 13 VIP, Handicapped Parking

# DOOR NUMBER  
 # KEY

# SCHEDULE

Band	#Marchers	Group	Perform	Arrive	Warm Up	Warm Up Area	PitLeaves Warm Up	Band Leaves Warm Up	Gate Time	Perform	Trucks Depart	Buses Depart
<b>Opening</b>												
Falls Church HS	32	1.1	10:00: AM	8:30: AM	8:50: AM	A	9:45: AM	9:55: AM	10:05: AM	10:15: AM	11:15: AM	1:00 PM
Loudon Valley HS	47	1.5	10:30: AM	8:45: AM	9:05: AM	C	10:00: AM	10:10: AM	10:20: AM	10:30: AM	11:30: AM	1:00 PM
Park View HS	39	1.3	10:45: AM	9:00: AM	9:20: AM	B	10:15: AM	10:25: AM	10:35: AM	10:45: AM	11:45: AM	1:00 PM
Woodgrove HS	36	1.2	11:00: AM	9:15: AM	9:35: AM	D	10:30: AM	10:40: AM	10:50: AM	11:00: AM	12:15: PM	1:00 PM
<b>Break</b>												
Annandale HS	41	1.4	11:30: AM	9:45: AM	10:05: AM	A	11:00: AM	11:10: AM	11:20: AM	11:30: AM	12:30: PM	1:00 PM
Rock Ridge HS	55	1.6	11:45: AM	10:00: AM	10:20: AM	C	11:15: AM	11:25: AM	11:35: AM	11:45: AM	12:45: PM	1:00 PM
James Wood HS	55	1.7	12:00: PM	10:15: AM	10:35: AM	B	11:30: AM	11:40: AM	11:50: AM	12:00: PM	1:00: PM	1:00 PM
<b>Break</b>												
Awards			12:30: PM									
Awards Done			12:45: PM									
<b>Break</b>												
Alexandria City HS	60	2.1	1:30: PM	11:45: AM	12:05: PM	D	1:01: PM	1:10: PM	1:20: PM	1:30: PM	2:30: PM	5:30 PM
Liberty HS	63	2.2	1:45: PM	12:00: PM	12:20: PM	A	1:15: PM	1:25: PM	1:35: PM	1:45: PM	2:45: PM	5:30 PM
South County HS	65	2.3	2:00: PM	12:15: PM	12:35: PM	C	1:30: PM	1:40: PM	1:50: PM	2:00: PM	3:00: PM	5:30 PM
<b>Break</b>												
Stonbridge HS	69	2.5	2:30: PM	12:45: PM	1:05: PM	B	2:00: PM	2:10: PM	2:20: PM	2:30: PM	3:30: PM	5:30 PM
Centerville HS	75	2.6	2:45: PM	1:00: PM	1:20: PM	D	2:15: PM	2:25: PM	2:35: PM	2:45: PM	3:45: PM	5:30 PM
Wakefield HS	80	2.7	3:00: PM	1:15: PM	1:35: PM	A	2:30: PM	2:40: PM	2:50: PM	3:00: PM	4:00: PM	5:30 PM
<b>Break</b>												
Dominion HS	84	3.2	3:30: PM	1:45: PM	2:05: PM	C	3:00: PM	3:10: PM	3:20: PM	3:30: PM	4:30: PM	5:30 PM
Okton HS	90	3.3	3:45: PM	2:00: PM	2:20: PM	B	3:15: PM	3:25: PM	3:35: PM	3:45: PM	4:45: PM	5:30 PM
Fairfax HS	103	3.4	4:00: PM	2:15: PM	2:35: PM	D	3:30: PM	3:40: PM	3:50: PM	4:00: PM	5:00: PM	5:30 PM
South Lakes HS	82	3.1	4:15: PM	2:30: PM	2:50: PM	A	3:45: PM	3:55: PM	4:05: PM	4:15: PM	5:15: PM	5:30 PM
<b>Break</b>												
Awards			4:45: PM									
Awards Done			5:00: PM									
<b>Break</b>												
Awards Done			5:15: PM									
<b>Break</b>												
John Champe HS	119	4.1	6:00: PM	4:15: PM	4:35: PM	C	5:31: PM	5:40: PM	5:50: PM	6:00: PM	7:00: PM	9:00 PM
West Springfield HS	120	4.2	6:15: PM	4:30: PM	4:50: PM	B	5:45: PM	5:55: PM	6:05: PM	6:15: PM	7:15: PM	9:00 PM
James Madison HS	120	4.3	6:30: PM	4:45: PM	5:05: PM	D	6:00: PM	6:10: PM	6:20: PM	6:30: PM	7:30: PM	9:00 PM
Freedom HS	123	4.4	6:45: PM	5:00: PM	5:20: PM	A	6:15: PM	6:25: PM	6:35: PM	6:45: PM	7:45: PM	9:00 PM
<b>Break</b>												
Langley HS	124	4.5	7:15: PM	5:30: PM	5:50: PM	C	6:45: PM	6:55: PM	7:05: PM	7:15: PM	8:15: PM	9:00 PM
Independence HS	130	4.6	7:30: PM	5:45: PM	6:05: PM	B	7:01: PM	7:10: PM	7:20: PM	7:30: PM	8:30: PM	9:00 PM
McLean HS	180	5.1	7:45: PM	6:00: PM	6:20: PM	D	7:15: PM	7:25: PM	7:35: PM	7:45: PM	8:45: PM	9:00 PM
Hendon HS			8:00: PM	6:15: PM	6:35: PM	A	7:30: PM	7:40: PM	7:50: PM	8:00: PM	9:00: PM	
<b>Break</b>												
Awards			8:30: PM									
Awards Done			9:00: PM									

# CONCESSIONS

## food

	A-la-carte	Meal*
Burgers Plain/Cheese	\$5.00	\$7.00
Hot Dogs	\$3.00	\$5.00
Corn Dog	\$3.00	\$5.00
Pizza Hut Personal Pizza Cheese	\$7.00	\$10.00
Pizza Hut Personal Pizza Pepperoni	\$7.00	\$10.00
Firehouse 6" Box Lunch with chips Turkey, Ham, or Roast Beef	\$8.00	\$10.00
Cup of Soup	\$3.00	\$5.00
Cup of Chili with Chips	\$5.00	\$7.00

\* **BURGERS, DOGS:** Make it a meal for \$2.00 more: add a chip, 2 pack Oreo, and soda or water (excludes sports drinks) Gluten free buns available upon request.

\* **PIZZA HUT, FIREHOUSE, CHILI or SOUP:** Add Oreo and soda or water (excludes sports drinks) for \$2.00 more

## snacks

Candy	\$2.00
Chips	\$1.00
Cookies and Treats	\$1.00

## drinks

Soda (12 oz cans)	\$2.00
Sports Drinks	\$3.00
Bottled Water	\$1.00

